

# Sentry Safe manual

SFW082GTC  
SFW123FTC  
SFW205GPC

**Safety reference: All codes are to be securely stored. Do NOT use personal data (i.e. Birthdays, telephonenumber, etc) as a code.**

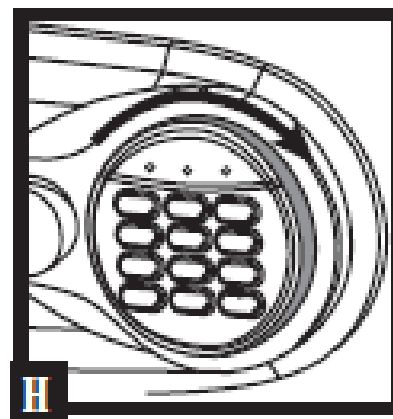

## First time opening the safe

First you will need to **install the batteries**. To power the lock, four alkaline AA batteries, equalling voltage 6Vdc (not included) are required. Non-alkaline and rechargeable batteries are **not** recommended.

To install batteries, turn the electric lock case to the right and remove (figure H). Insert four new batteries as indicated, replace the electric lock case and turn to the left to reassemble.

For added security, some models (SFW082GTC and SFW205GPC) have dual locking system (electronic lock plus key lock). You must use both the electronic code and the key to open the safe.

Now you will have to enter the electronic lock combination. You will find this combination on the manual which is supplied with the safe. See below:

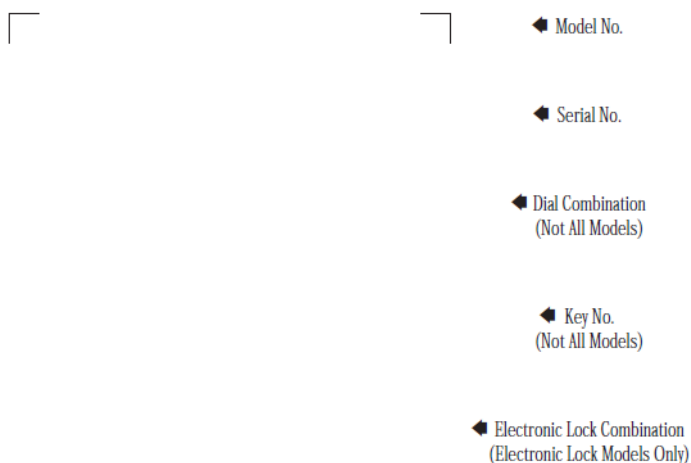

Only a light touch is needed. A green PROCEED light and a single beep indicate that the keypad "felt" your touch. The lock allows 5 seconds for each key press. If you pause longer, an error signal will occur (blinking red light and three beeps), indicating you should start over.

## Access codes

There are three possible ways to unlock and access the safe—by entering its preset 5-digit electronic lock combination, your own user code or a user PIN (Personal Identification Number).

You can always open the safe by entering the 5-digit electronic lock combination. This code **can not** be deleted. But if you prefer to employ your own code, you can program the safe to open to the 5-digit user code of your choice. If you wish to give someone else temporary access to the safe, you can program a 5-digit user PIN that can later be erased.

### Programming a 5-digit user code

1. Press the Program key.
2. Enter the electronic lock combination. The green LED remains on while you enter the 5-digit user code of your choice. After 5 digits are entered the green LED turns off.

To enter a new user code, repeat these steps.

To erase the user code, press the Program key and enter your electronic lock combination twice.

### Programming a 5-digit user PIN

**Note:** You must program a user code before programming a user PIN.

1. Press the Program key.
2. Press it a second time.
3. Enter your 5-digit user code. The green LED remains on.
4. Enter the 5-digit user PIN of your choice (any combination except **00000**). After 5 digits are entered the green LED turns off.

To enter a new user PIN, repeat these steps.

To erase the user PIN, press the Program key twice, enter your user code and then enter **00000**.

# Sentry Safe manual

SFW082GTC

SFW123FTC

SFW205GPC

## Open unit first, then test with door open!

Always test your new electronic lock combination several times with the door **open**, to make sure you have recorded it correctly. Your new electronic lock combination is ready to use.

## Battery replacement

When old batteries are removed for replacement, your user PIN will be voided; only electronic lock combination and user code will work. To reestablish your user PIN, follow the directions above under "Programming a 5-digit user PIN".

**Note:** If your safe does not appear to be working, please always check your batteries first.

## Signals

Your electronic lock safe communicates by means of several audio/visual signals.

### **Red (error) LED + three beeps indicates one of the following:**

1. You have pressed Program key out of sequence
2. You have entered an invalid code or user pin
3. You have let 5 seconds or more elapse between key entries

### **Green (proceed) LED + single beep occurs:**

After entering each digit of electronic lock combination, user code, or user PIN

2. After pressing Clear key
3. After pressing Program key

### **Green LED only:**

1. Comes on after you enter a valid code/user PIN and remains lit during the 4-second period in which the safe can be opened
2. Comes on in the Program user code mode after you enter the electronic lock combination and remains lit until you have finished entering a 5-digit user code
3. Comes on in the Program user PIN mode after you have entered your user code and remains on until you have entered a 5-digit user PIN

### **Yellow LED:**

Indicates "low battery" and will typically not turn on until battery has been in use two years or longer.

Your electronic lock automatically performs a low battery test during each lock use.

If a "low battery" condition is detected the yellow LED will come on and remain on during each subsequent lock operation. (The lock will continue to function in a low battery state, until battery failure.) The yellow LED will turn off only after the low batteries are replaced. (Note: If the new batteries are installed in less than 60 seconds the yellow LED may come on and stay on during the first lock operation before it returns to off.)

**Note:** It is recommended you replace the batteries after two years, or the the yellow LED remains on.

**Safety reference: All codes are to be securely stored. Do NOT use personal data (i.e. Birthdays, telephonenumber, etc) as a code.**

## Delay mode

The lock automatically enters a two-minute delay mode after an invalid code has been entered three consecutive times. In this mode, the lock can not be activated and any key entry will generate an error signal.

## Instructions for floor mounting

### **This kit contains:**

2 lag screws, 2 washers and 2 masonry anchors (Fig. A)

### **Tools needed for floor mounting:**

Drill, wrench, 11 mm drill bit, for wood anchoring 7,2 mm drill bit, for masonry anchoring 9,5 mm masonry drill bit.

### **Instructions:**

1. Tip the safe onto its right side (door hinges horizontal with the floor).
2. Unlock the safe and open the door.
3. Look on the bottom of the safe for two indentations in opposite corners. Using the 11 mm bit, drill a hole through each indentation perpendicular to the bottom of the safe (Fig. B).
4. Close the door and tip the safe upright. Place it where desired and reopen the door.
5. Use a screw or drill bit to mark the floor through both holes (Fig. C).
6. Move the safe aside to clear both marked spots for drilling.
7. Drill into the floor:
  - A. For wood: using the 7,2 mm bit, drill a hole 64 mm deep in each marked spot (Fig. D).
  - B. For masonry: using the 9,5 mm bit, drill a hole 64 mm deep in each marked spot (Fig. D). Install a masonry anchor in each hole.
8. Replace the safe in the desired position, with the holes in the safe aligned with those in the floor.
9. Securing the safe:
  - A. For wood: pass each lag screw through a washer, then through the safe and into a hole. Tighten with the wrench (Fig. E).
  - B. For masonry: pass each lag screw through a washer, then through the safe and into a masonry anchor. Tighten with the wrench (Fig. F).

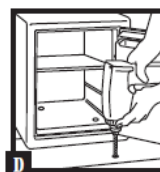
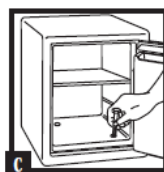
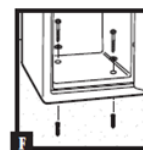
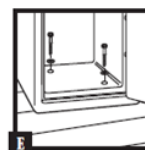
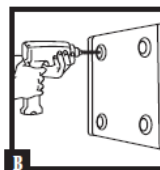

# Sentry Safe manual

SFW082GTC

SFW123FTC

SFW205GPC

**Safety reference: All codes are to be securely stored. Do NOT use personal data (i.e. Birthdays, telephonenumber, etc) as a code.**

## Warning!

**DO NOT** store delicate items directly in your safe.

Sentry Safe products which offer fire protection have a patented insulation that has a high moisture content. In addition the Sentry Safe advanced safes close airtight to offer water resistance, which may also cause moisture to accumulate inside your safe. The desiccant packet included in your safe during shipment, should be left in your safe.

**DO NOT DISCARD IT.**

It is intended to help absorb moisture which may accumulate inside your safe. If you choose to store delicate items such as jewelry with working parts, watches, stamps, or photos in your safe, we recommend putting them in an air-tight container, prior to placing them in the safe for storage.

## Warning!

**DO NOT** store pearls in this safe unit.

In the event of a fire, potential damage to delicate pearls occurs at temperatures much lower than the 350°F interior performance measure which the UL classification performance standard indicated guarantees. Therefore, **DO NOT** store pearls in your Sentry Safe product.



**De Raat**  
Security Products

*safes, lockers and more...*